

UMEC International Corporation

UP0601C SERIES

26-65 Watt AC/DC Open Frame

- ◆ Universal Input 90 to 264 VAC
- ◆ EMI Meets FCC/CISPR 22 Class B
- ◆ Continuous Short Circuit Protection
- ◆ MTBF 300Khrs
- ◆ UL/cUL, TUV, and CE approval
- ◆ RoHS Compliant

Green Product
RoHS

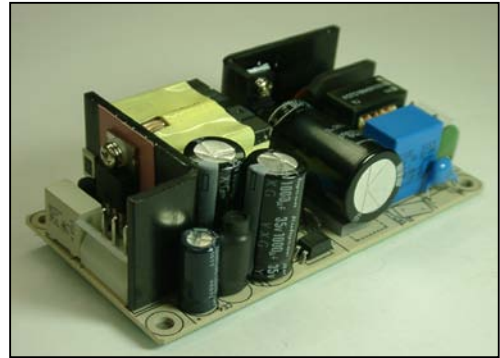

SPECIFICATIONS

All specifications are typical at nominal line, full load and 25°C unless otherwise noted.

INPUT SPECIFICATIONS

Input Voltage Range 90-264VAC
Input Frequency 47-63 Hz
Inrush Current 80A max. @230VAC(Cold Start)
40A max. @110VAC(Cold Start)

GENERAL SPECIFICATIONS

Hold-up Time 10mS typ.
Leakage Current 3mA max.
Short Circuit Protection Continuous
Continuous Output Power 26~60W max.
Hi-pot Isolation: Input / Output 4242 VDC

ENVIRONMENTAL SPECIFICATIONS

Operating Temperature Range 0°C to 70°C
Derating 50°C to 70°C 2%/°C
Temperature Coefficient ±0.02%/°C
Storage Temperature Range -40°C to +85°C
Humidity, Non-Condensing 0 to 95% RH
Cooling Free- Air Convection
EMI Meets FCC/CISPR 22 Class B Specification



UMEC International Corporation
2570 West 237th Street, Suite B
Torrance, California 90505 USA

www.umecintl.com
Tel: 310-326-7072
Fax: 310-326-7058

UMEC International Corporation

OUTPUT SPECIFICATIONS

Model Number	Output Voltage (Volts)	OVP ³	Output Current (Amps)		Max Power (Watt)	Efficiency (typ.)	Ripple ¹ P-P (mV)	Total Regulation ²
			Min.	Rated				
UP0601C-03	3.3	✓	0	8	26.4	72%	50	±4%
UP0601C-05	5	✓	0	8	40	76%	50	±4%
UP0601C-09	9	✓	0	6	54	80%	90	±4%
UP0601C-12	12	✓	0	5.4	65	82%	120	±4%
UP0601C-15	15	✓	0	4.3	65	82%	150	±4%
UP0601C-18	18	✓	0	3.6	65	82%	180	±4%
UP0601C-24	24	✓	0	2.7	65	84%	240	±4%
UP0601C-29	29	✓	0	2.2	65	84%	290	±4%
UP0601C-48	48	✓	0	1.35	65	84%	480	±4%

NOTES:

1. Add a 0.1uF ceramic capacitor and a 10uF E.L. capacitor to the output connector. Peak to peak and RMS metering equipment shall have a 20 MHz response with probes and cables maintaining frequency response from 200 Hz to 100MHz bandwidth. Output ripple and spikes are measured directly at the output terminals of the power supply without the use of the probe ground clip.
2. Total regulation is defined as the static output regulation at 25°C, including initial tolerance, line voltage and load current within stated limits.
3. When the OVP occurred in model UP0601C-XX series, the power supply will be shouted down & auto-recovery except UP0601C-48 which will be shouted down & latched (The OVP is reset by removing the input power for 10 minutes.)

PHYSICAL SPECIFICATIONS

Weight: 150g

UP0601C-XX

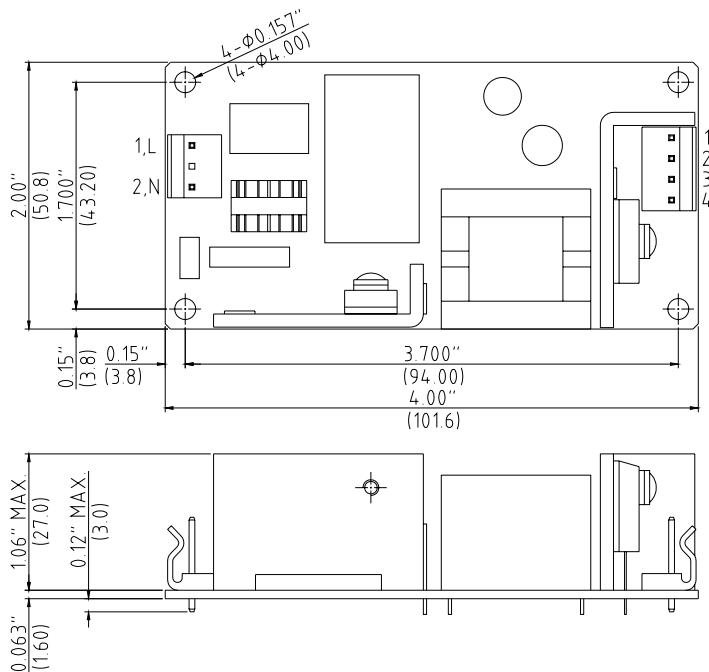

CN1 input connector Molex 09-65-2038 with second pin removed	
Pin	Input voltage
L&N	90-264 VAC

CN2 output connector Molex 09-65-2048 4Pin or equivalent	
Model	
Pin	UP0601C-XX
1	Vo
2	Vo
3	Common
4	Common

NOTES:

1. All dimensions in inches (mm).
2. Tolerance .XX=±0.04", .XXX=±0.010"



UMEC International Corporation
2570 West 237th Street, Suite B
Torrance, California 90505 USA

www.umecintl.com
Tel: 310-326-7072
Fax: 310-326-7058

UMEC International Corporation

UP0601C-XXC1(PCB Mounted type)

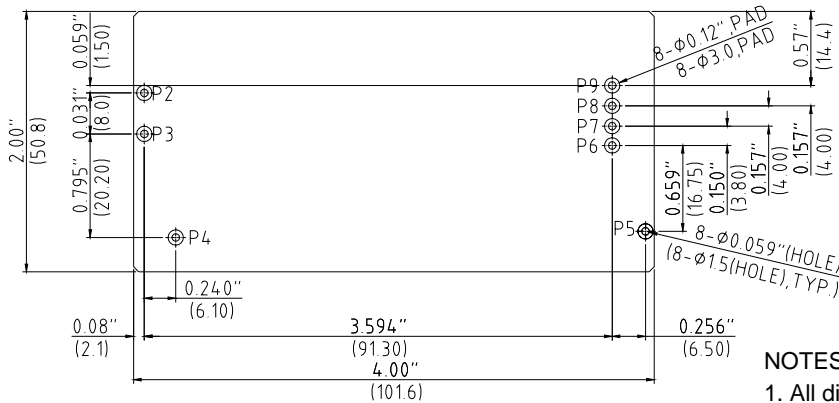
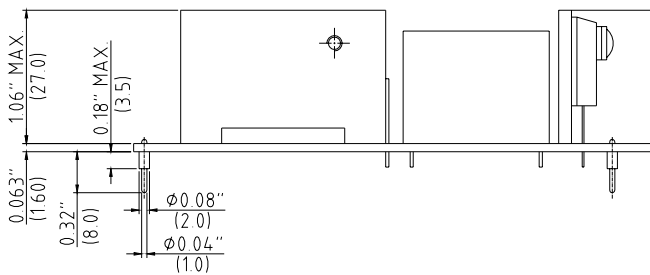
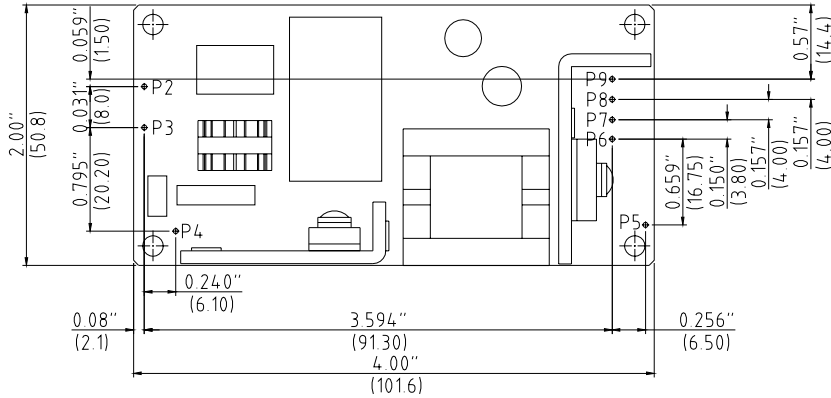

PCB layout recommend

NOTES:

1. All dimensions in inches (mm)
2. Tolerance .XX= ± 0.04 ", .XXX= ± 0.010 "

PIN Assignment										
UP0601C										
Pin	Description	-03C1	-05C1	-09C1	-12C1	-15C1	-18C1	-24C1	-29C1	-48C1
P4, P5	FG	✓	✓	✓	✓	✓	✓	✓	✓	✓
P2	L	✓	✓	✓	✓	✓	✓	✓	✓	✓
P3	N	✓	✓	✓	✓	✓	✓	✓	✓	✓
P6	Common	✓	✓	✓	✓	✓	✓	✓	✓	✓
P7	Common	✓	✓	✓	✓	-	-	-	-	-
P8	Vo	✓	✓	✓	✓	✓	✓	✓	✓	✓
P9	Vo	✓	✓	✓	✓	-	-	-	-	-



UMEC International Corporation
2570 West 237th Street, Suite B
Torrance, California 90505 USA

www.umecintl.com
Tel: 310-326-7072
Fax: 310-326-7058